

G GROUND LEVEL

- WESFARMERS GALLERY
Ngalang Koort Boodja Wirn
Our heart, Country, spirit
- Woodside Learning Studios

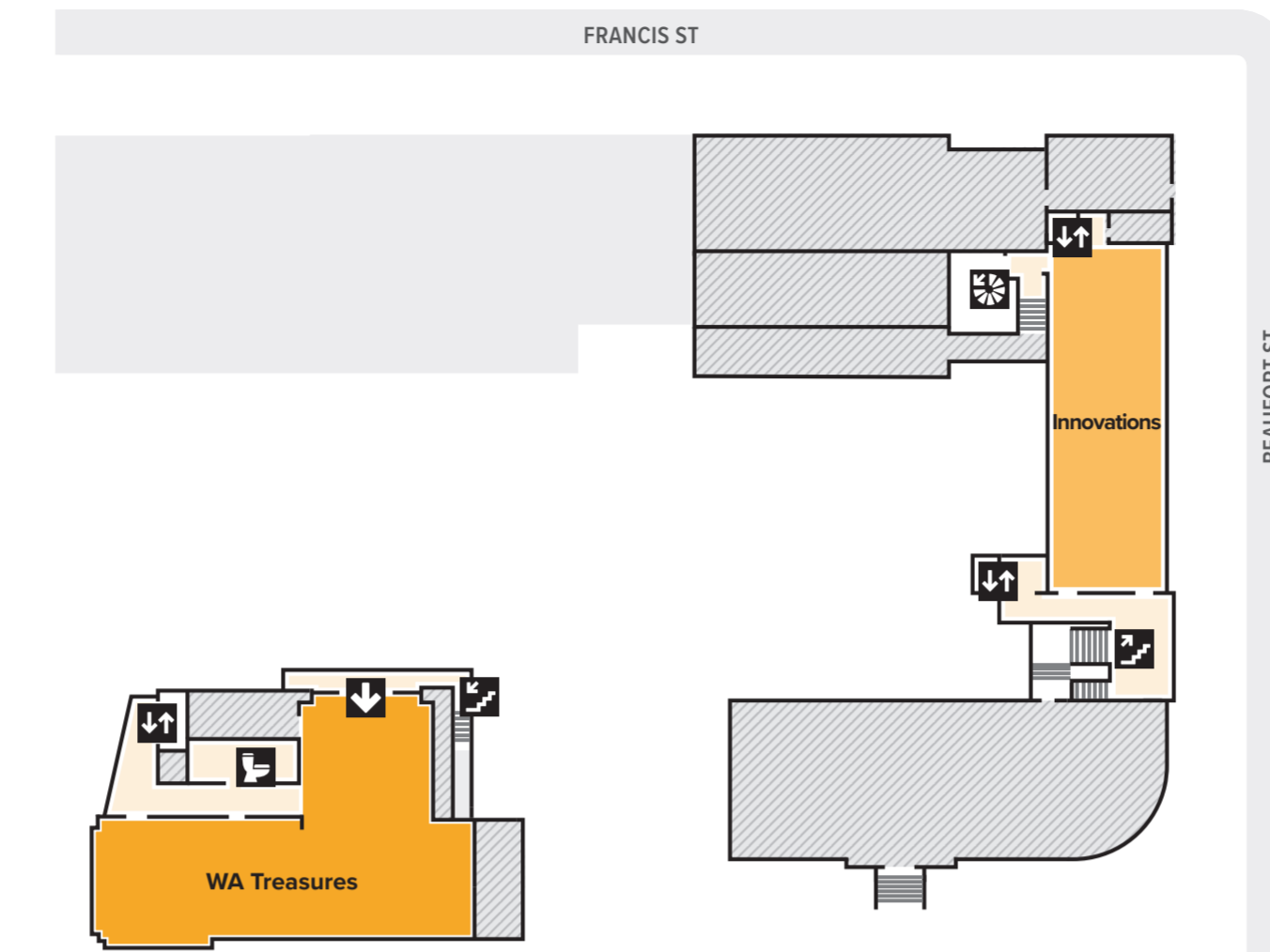

M MEZZANINE LEVEL

- RIO TINTO GALLERY
Innovations
Creative minds, amazing ideas
- *Stan Perron WA Treasures*
Highlights from the State's collections

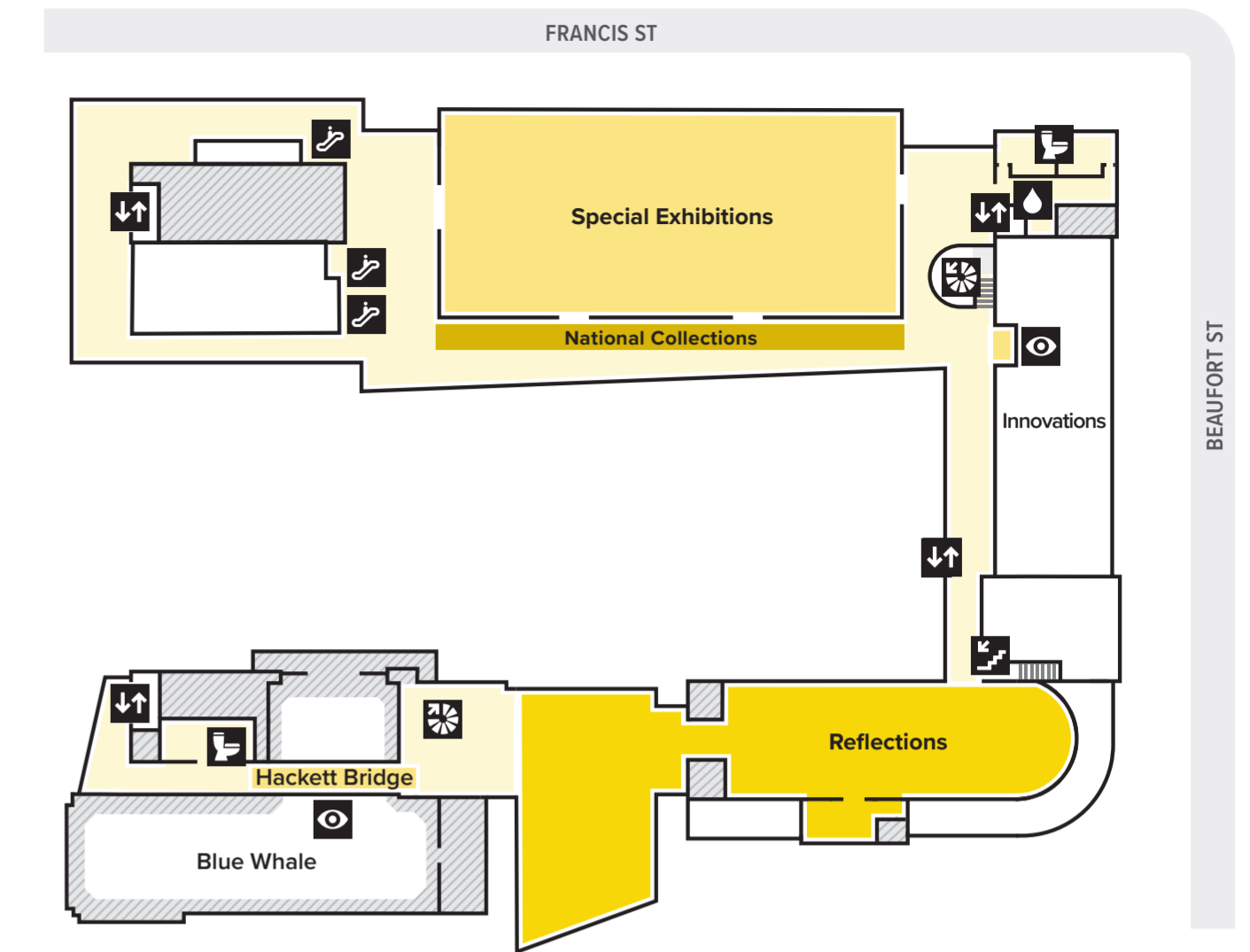

1 LEVEL ONE

- Special Exhibitions
- *Reflections*
Our people, our stories
- Collections from the National Museum of Australia

KEY

- No access area
- Entry
- Information desk
- Shop
- Café
- Viewing point
- Water station
- Escalator
- Lift
- Stairs
- Restrooms



Visitor information

- Access**
All entry points have universal access. Six public lifts are available.
- Cloaking**
Available at the information desk. Storage is not available for large or bulky items.
- Equipment**
Wheelchairs and walking aids are available from the information desk.
- First aid**
Ask a staff member for assistance.
- Food & drink**
Not allowed inside exhibitions. A café is located on the ground level.
- Information desk**
General and ticketing information. Located at the main entry.
- Lost & found**
Located at the information desk.
- Photography & filming**
Allowed unless otherwise stated. Flash photography is not permitted. Photography and filming for commercial purposes must have written approval from the Museum.
- Restrooms & quiet spaces**
Gender neutral, female, male and universal access toilets are located on each level. Baby changing facilities are available in each universal access restroom. Lounge seating is available outside all exhibitions. The Old Gaol Hub also has small rooms with soft seating.
- Wi-Fi**
Public Wi-Fi is available.

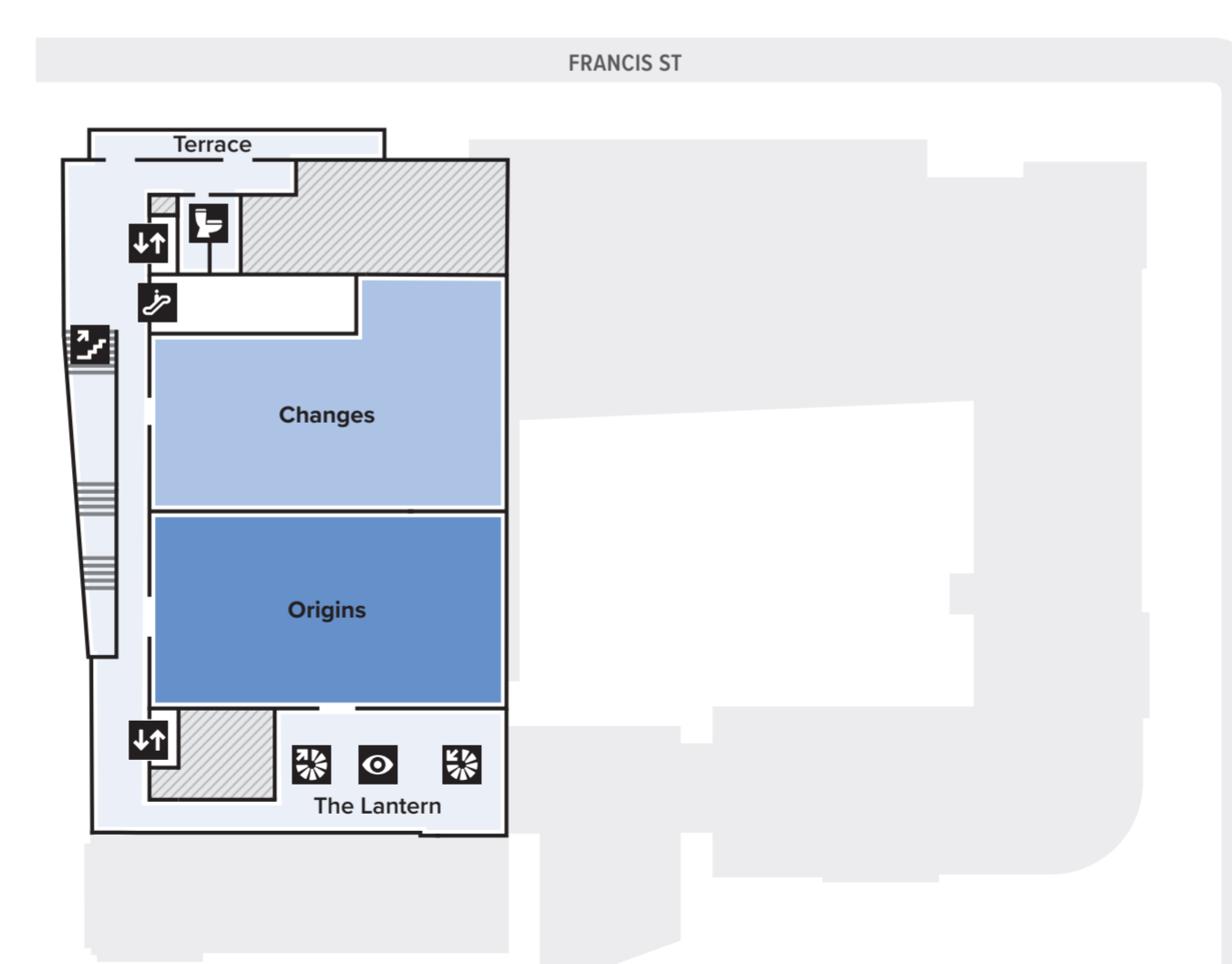

2 LEVEL TWO

- *Changes*
Transforming landscapes
- *Origins*
Land, water, sky

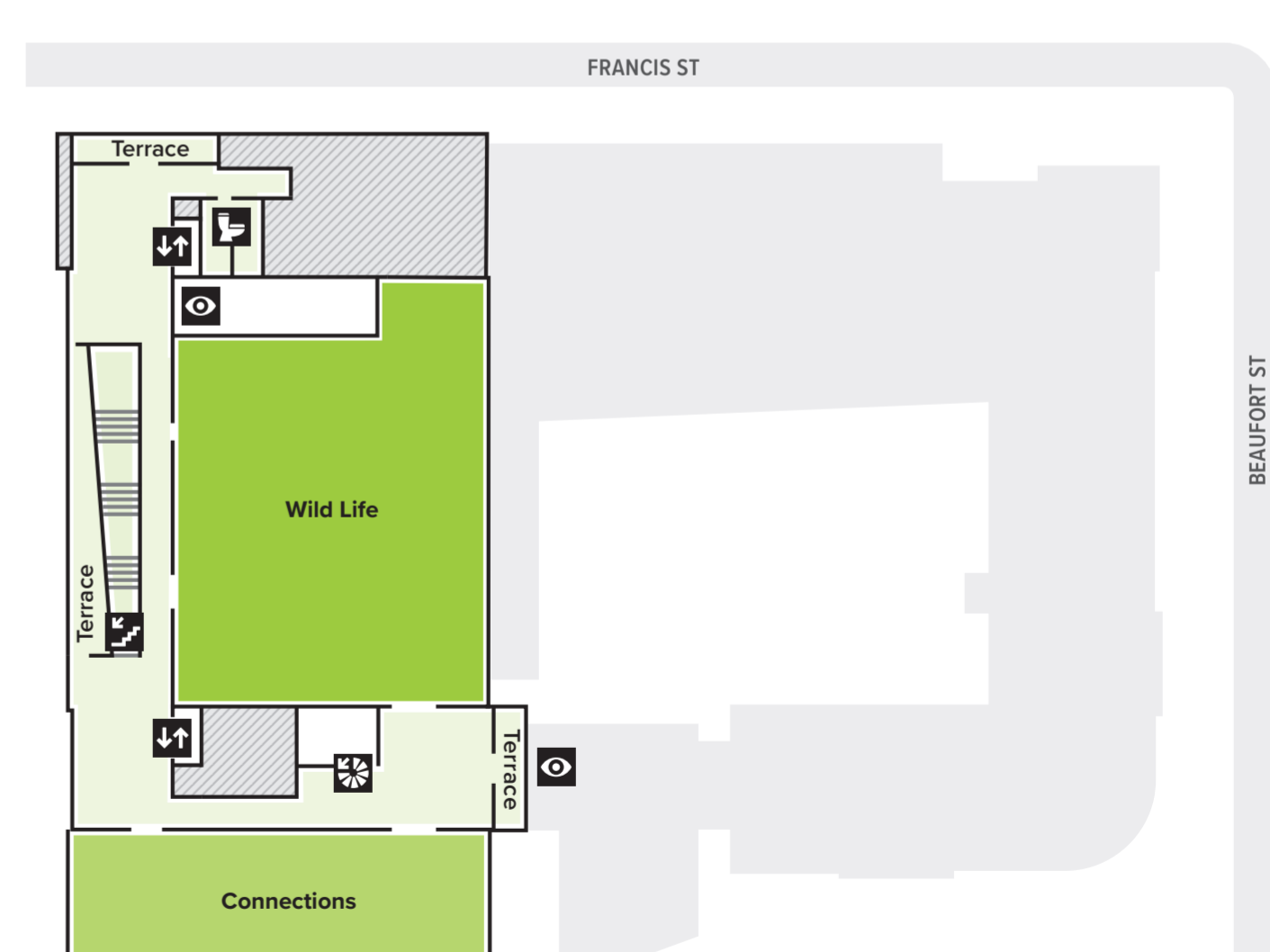

3 LEVEL THREE

- *Wild Life*
Discover nature's diversity
- TIANQI LITHIUM GALLERY
Connections
Our place in the world