



Photo: Sandie Bertrand

## Your boutique event space in Fremantle's historic heart

Host your next event in one of Fremantle's first buildings—the 1850s-era Commissariat—now WA Shipwrecks Museum. Steeped in history, this wonderfully restored event space in the heart of Fremantle is 250 metres from beautiful Bather's Beach and offers an experience your guests will never forget.

Nestled within the Museum, the space features polished concrete floors, original limestone walls and timber beams across the arched ceiling. It is perfect for an intimate wedding ceremony and cocktail reception, a unique corporate function, or a cherished family gathering. The space can incorporate seating or standing events in a variety of formats.

SEATED CAPACITY **60**

STANDING CAPACITY **100**



## INFORMATION AND BOOKINGS

Telephone: (08) 9221 4110  
[heydershears.com.au/contact](https://heydershears.com.au/contact)

**Look no further than WA Shipwrecks Museum for a classic Fremantle event experience.**

# HOSPITALITY & VENUE HIRE

## Floorplan

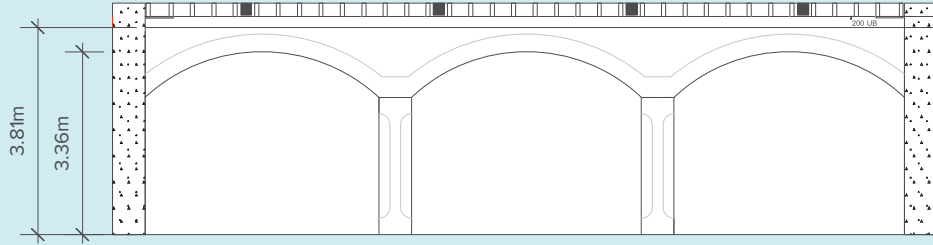

Cross Section

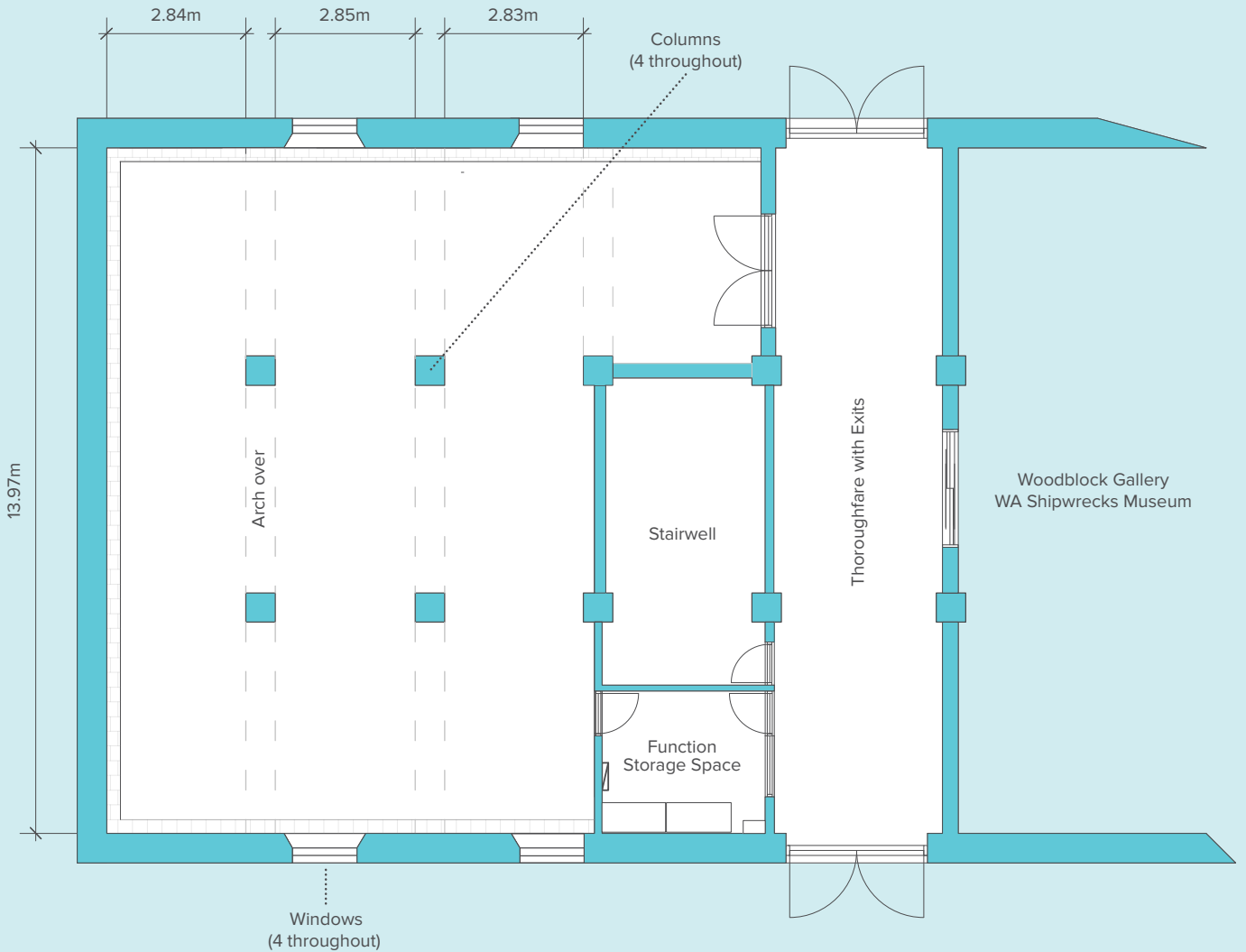

WA  
SHIPWRECKS  
MUSEUM