

TO THE MOON

EXHIBITION SENSORY GUIDE

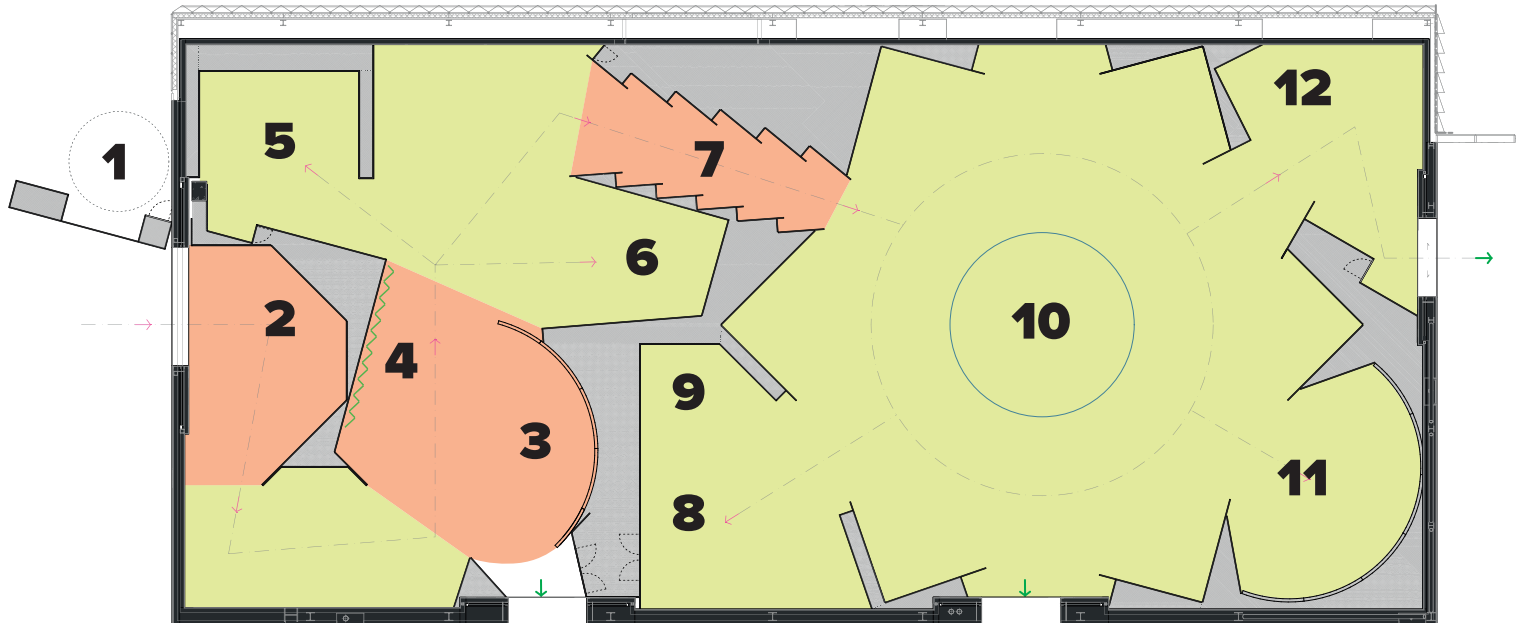

WA MUSEUM
BOOLA BARDIP



LOW STIMULATION

HIGH STIMULATION

- 1.** Lighthouse artwork – slow flashing lights.
- 2.** Video of the Moon Landing, archive footage and music. Played on loop (duration 3 minutes).
- 3.** Large video wall created with multiple tv screens. Snippets of media, film, and music. Sound is loud and jumps around the wall. Played on loop.
- 4.** Row of small screens with audio played through headphones.
- 5.** Living room installation with small tv screen, medium audio.
- 6.** Interactive drawing on iPads. Artwork shown on large screen.
- 7.** Walk-way with flashing multicoloured lights and sound.
- 8.** VR Experience – red flashing lights.
- 9.** Documentary video (duration 15 minutes).
- 10.** Large moon installation, mostly ambient sounds, and music with intermittent loud noise.
- 11.** Interactive floor projection, footsteps on the moon.
- 12.** Documentary video (duration 7 minutes).

This exhibition uses extreme contrast and flashing lights.

The lighting will be altered and the sound lowered for the Quiet Morning sessions.