

Visual story: Accessing the 'To the Moon' Exhibit

A step-by-step visual and written guide for visitors attending the 'To the Moon' exhibit.

What is a Visual Story?

Visual stories are simple and easy to follow. They help people get ready for new places or situations by making things more predictable.

This makes the process feel familiar and reduces anxiety and stress.

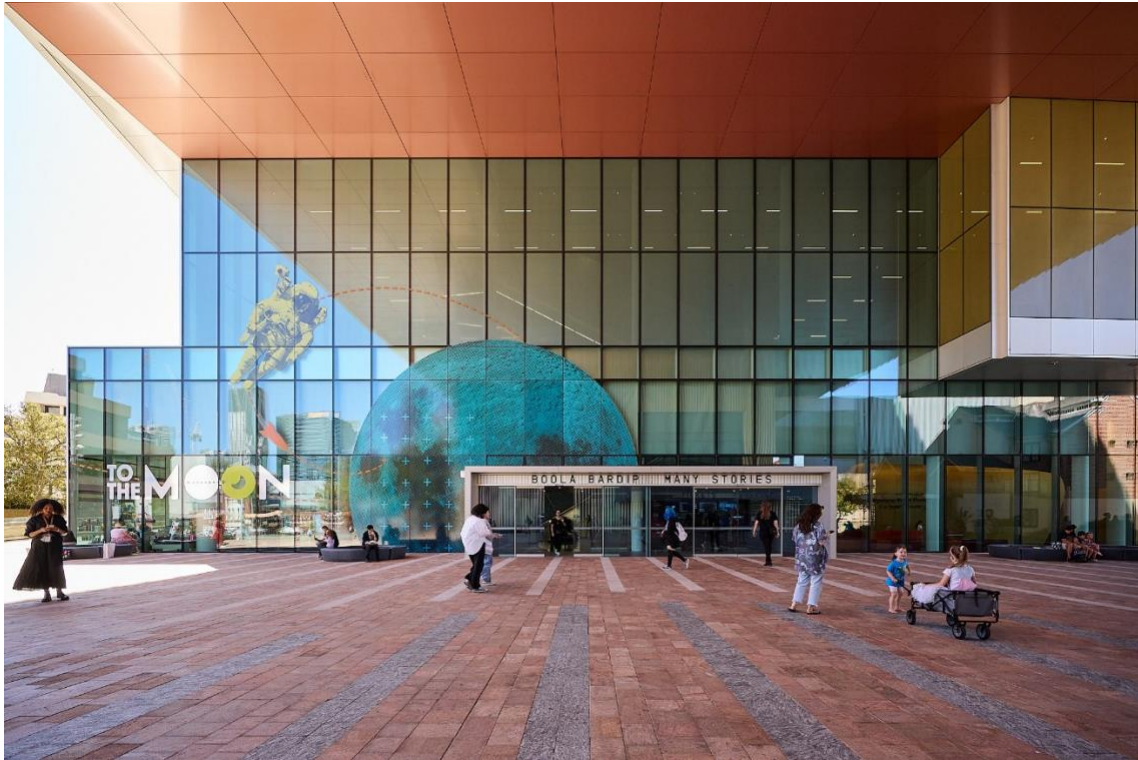

The WA Museum Boola Bardip is located in the Perth Cultural Centre on James Street, Northbridge.

To get there:

- Go to the Perth Cultural Centre on James Street, Northbridge.
- The Museum is open every day from 9:30 am to 5:00 pm.
- You can take the free blue CAT bus, or walk from Perth Train station.
- Inside, you will find many interesting displays, including the 'To the Moon' exhibition on level one.

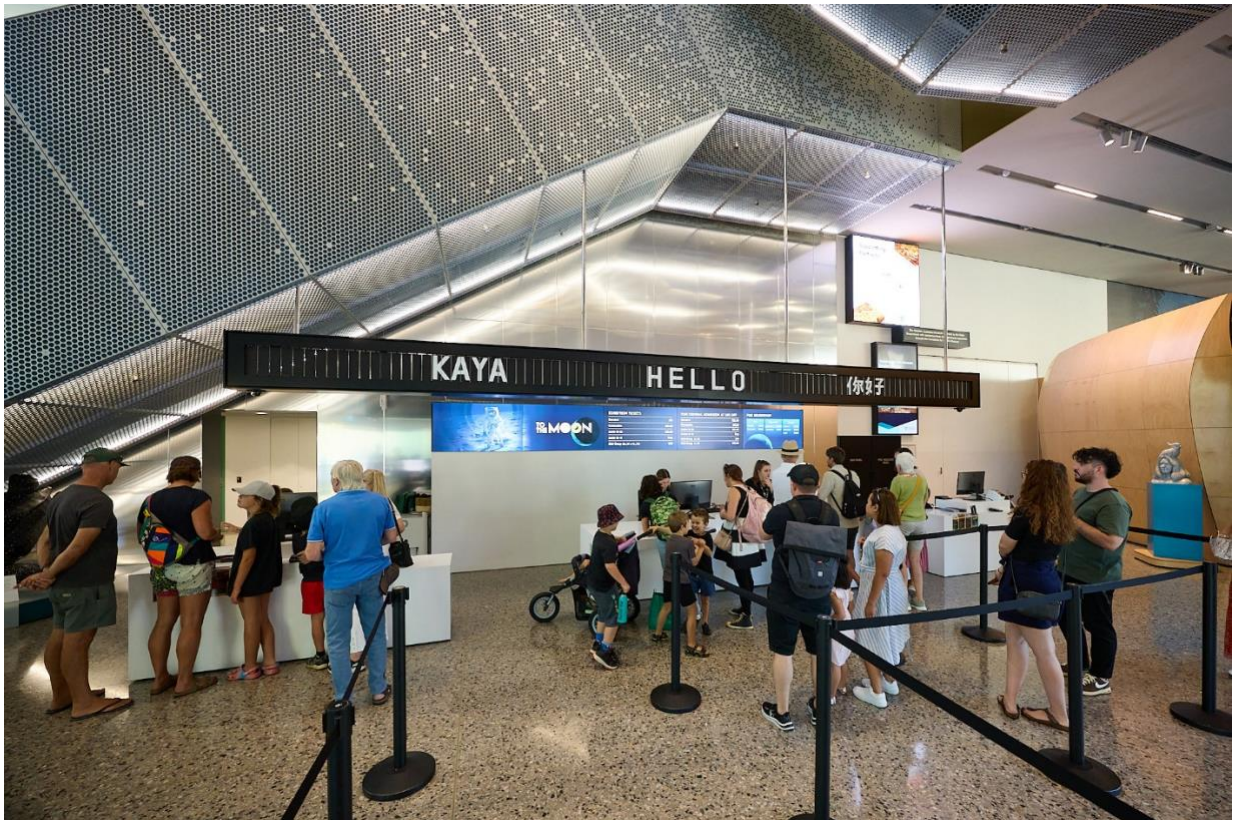

Once you walk in, you can line up for tickets and admission. There is plenty of room for prams and wheelchairs. This is the Ground Floor.

The WA Museum is part of the Companion Card program. If you have a Companion Card, you can get free entry for your companion.

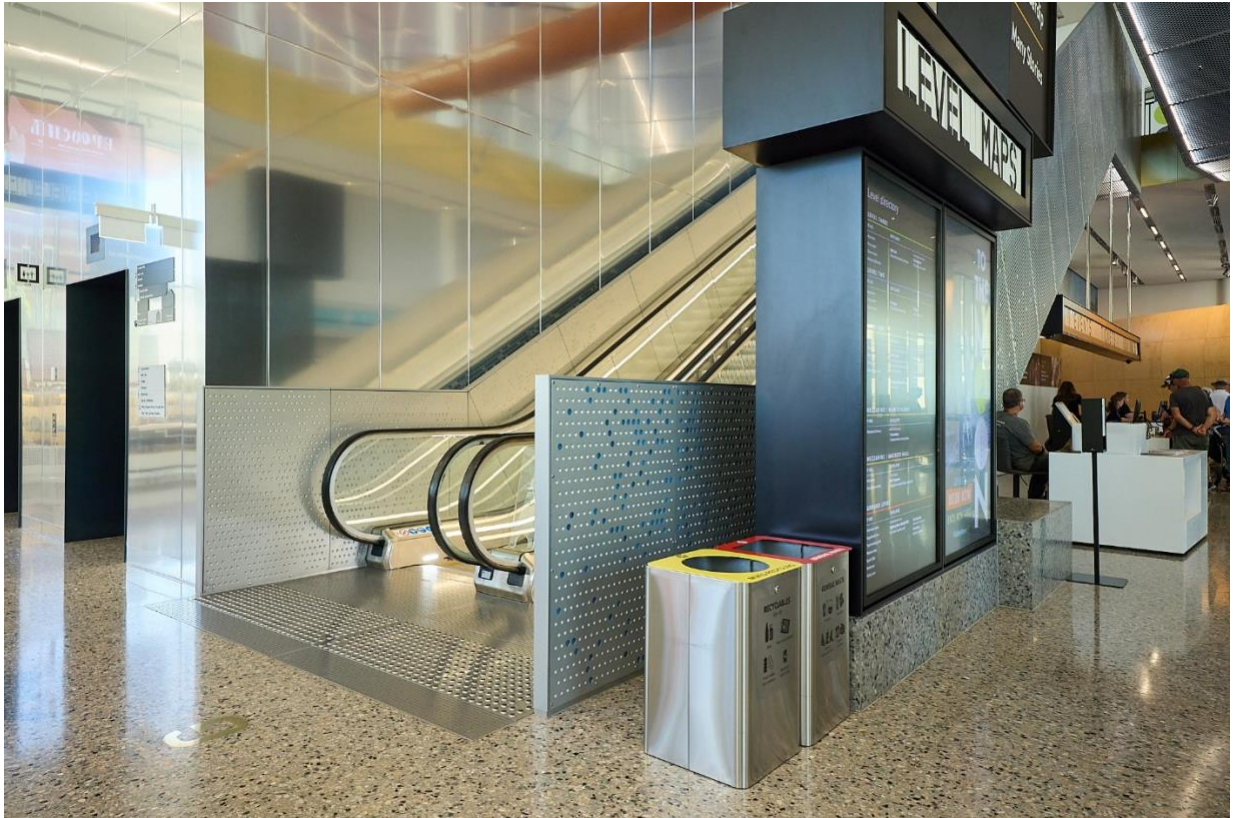

Once you have purchased your tickets, if you turn left, you will see an escalator that will take you up to the exhibit. There are also elevators.

You will want to go to Level 1 for the 'To the Moon' exhibit.



Once you have come up using the escalator or the elevator, you will find the entrance to the 'To the Moon' exhibit.



As you make your way into the exhibition, a friendly volunteer will greet you and check your ticket. Now you are free to explore!

As you make your way inside, be sure to notice the tiny 1960s loungeroom display built inside the wall - it's a sneak peek of what's to come. Inside you will find a life-size re-creation of that very same room.



Once you are inside, you will see a short video clip of the Moon landing on the wall. You will also find a music lyric quote about the Moon. See how many different song lyrics you can find throughout the exhibition!



As you explore, you will discover artworks and stories from Aboriginal and Torres Strait Islander perspectives on the Moon. Learn about the cultural significance and spiritual connections that have been passed down through generations and gain a deeper understanding of the Moon's importance in Aboriginal and Torres Strait Islander culture.



Next, you will see a display of TV screens referring to the Moon through clips of old movies and TV series by artist Field Carr. Sit down, relax, and enjoy show!

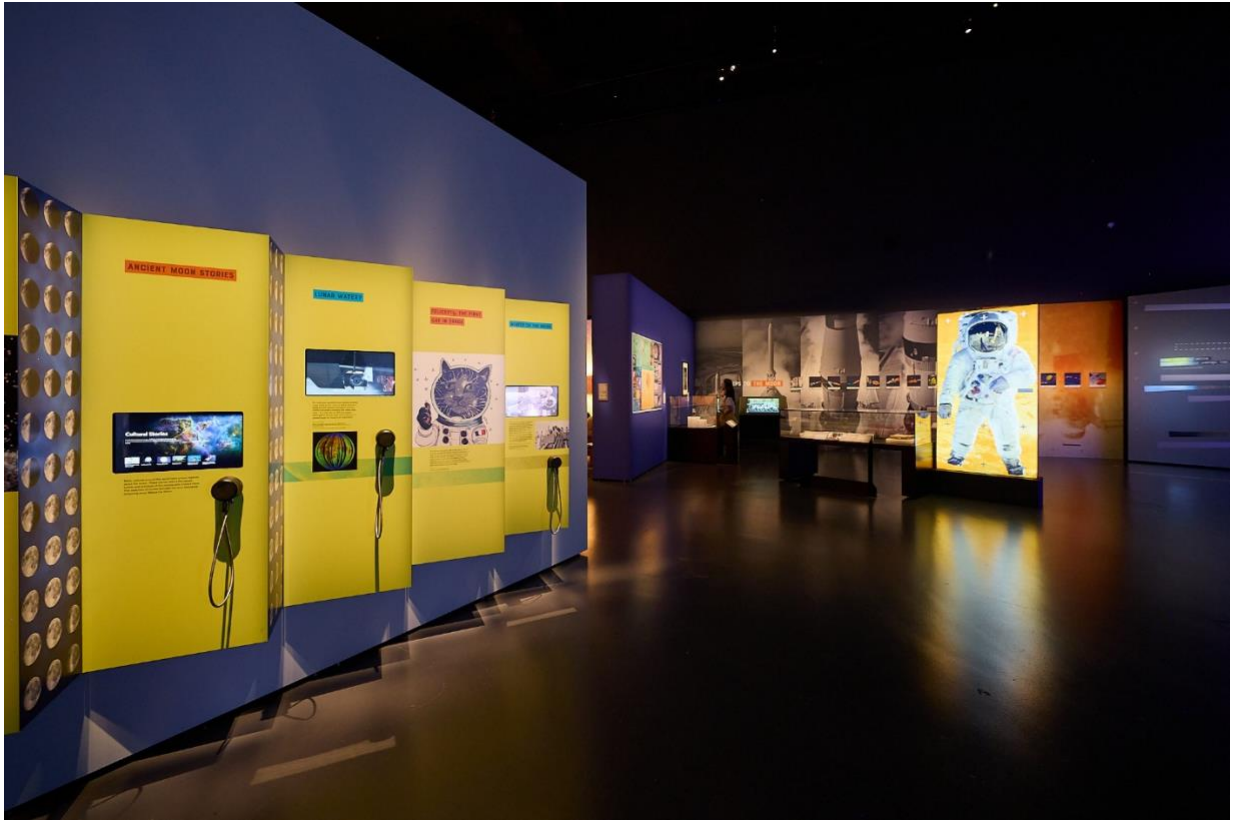

After the TV clips, head over to the listening station on the wall. Pick up an earphone and listen to fascinating stories, myths, and legends about the Moon.



Turn left and you will find the 1960s lounge room you saw the miniature version of at the entrance - now life-size!

It's filled with retro furniture and a TV.

Watch and listen to a special artificial-intelligent created video that showcases what would have happened if the Moon landing had failed. There's plenty of space for a pram or wheelchair.

After you have finished, you can learn more about the making of the video and see behind-the-scenes secrets on the nearby screen.



After which, you can turn to the right and see a wall display of information and facts, featuring various object displays.





Ready for some interactive fun? Take a seat at the gaming console and get creative! Colour in a mini 'spaceship or astronaut' and watch as it comes to life on the big screen in front of you.



As you wander along the walkway, you'll be surrounded by an immersive experience! The walls will transform with vibrant colours, while the sounds of a rocket blasting off fills the air. The journey builds up to a breathtaking encounter with a gigantic, detailed moon.



As you walk around in a circle around the Moon, feel free to sit, relax and read up on more moon-related facts.



Try our interactive station and write a moon poem! Use your imagination and write what you think and feel about the moon. It is a fun and creative experience!



As you then step into our Luna Lounge, one of our volunteers will help you take a turn at Virtual Reality (VR). See what it is like in space. Afterwards, sit down and watch a few clips of astronauts talking about what it is like living at the International Space Station.



Walk on the Moon! Well, sort of... Our special moonscape makes it look like you're really there. See your footprints like they're on the Moon, and pretend you are looking at our planet Earth on the screen.

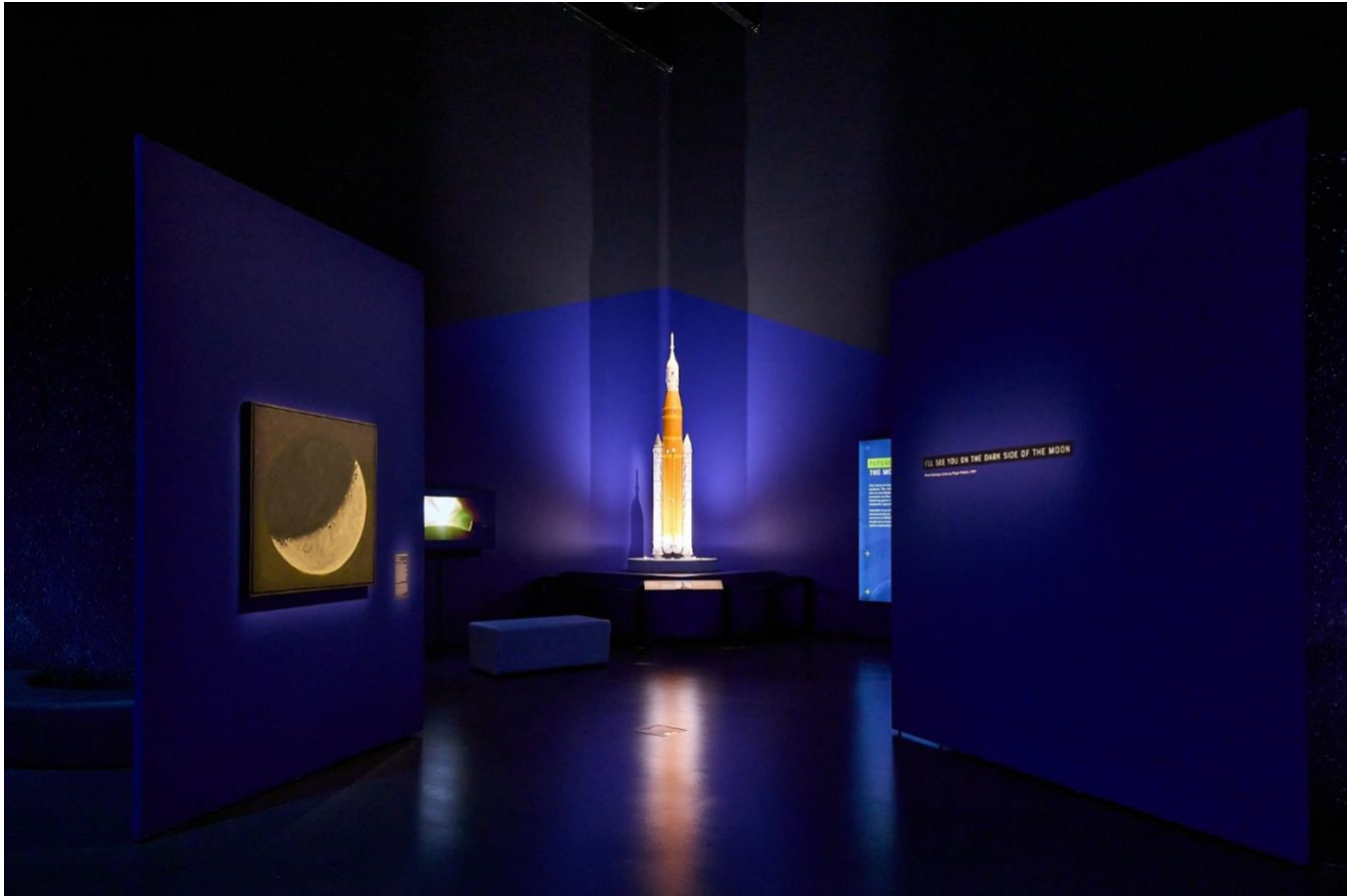

Explore more cool space facts and watch a short video! Plus, check out a rocket ship model. It's a great way to wrap up your moon adventure.



One or two last little interactive activities will send you off as you leave. Interact with the planetary alignments and watch the mesmerising colours of the Noon dust fill the vertical screen.

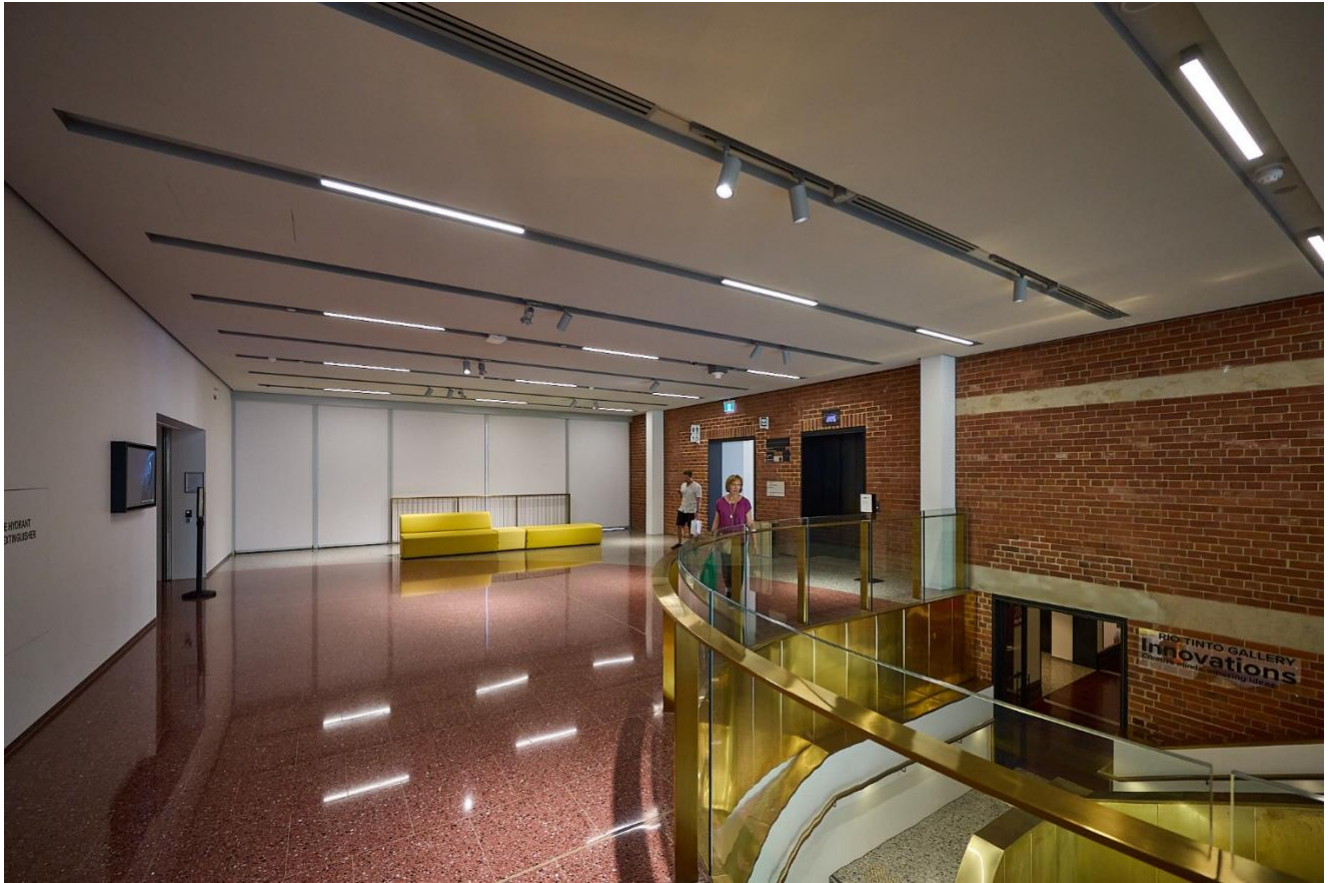

As you leave, feel free to try VR again with the additional volunteers available to help. For a more relaxed experience, the exhibition will have extra VR headsets set up in this area.

You can exit down the escalators, with bathrooms located in front of you as you exit the exhibition.

We hope you have enjoyed your experience.
Please come again soon!

If you want to know more about accessibility at the Boola Bardip WA Museum, read our [Accessibility Visitor's Guide](#).