

Visual story: Accessing the 'OceanXperience' Exhibit

A step-by-step visual and written guide for visitors attending the "OceanXperience" exhibit.

What is a Visual Story?

Visual stories are simple and easy to follow. They help people get ready for new places or situations by making things more predictable.

This makes the process feel familiar and reduces anxiety and stress.



The WA Museum Boola Bardip is located in the Perth Cultural Centre on James Street, Northbridge.

- The museum is open every day from 9:30 am to 5:00 pm.
- Inside, you will find many interesting displays, including the 'OceanXperience' exhibit.

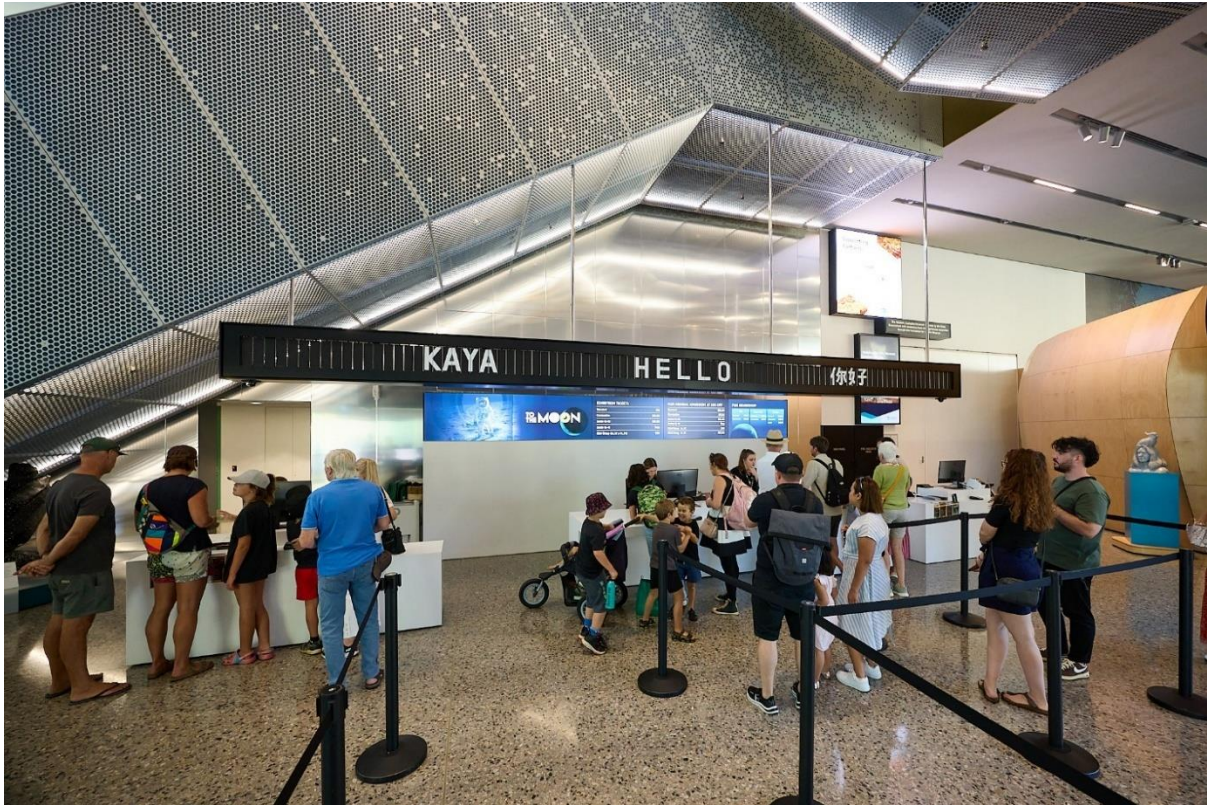

When you enter the museum, you can line up for tickets and admission. There is plenty of room for prams and wheelchairs. This is the Ground Floor.

The WA Museum is part of the Companion Card program. If you have a Companion Card, your companion can enter for free.

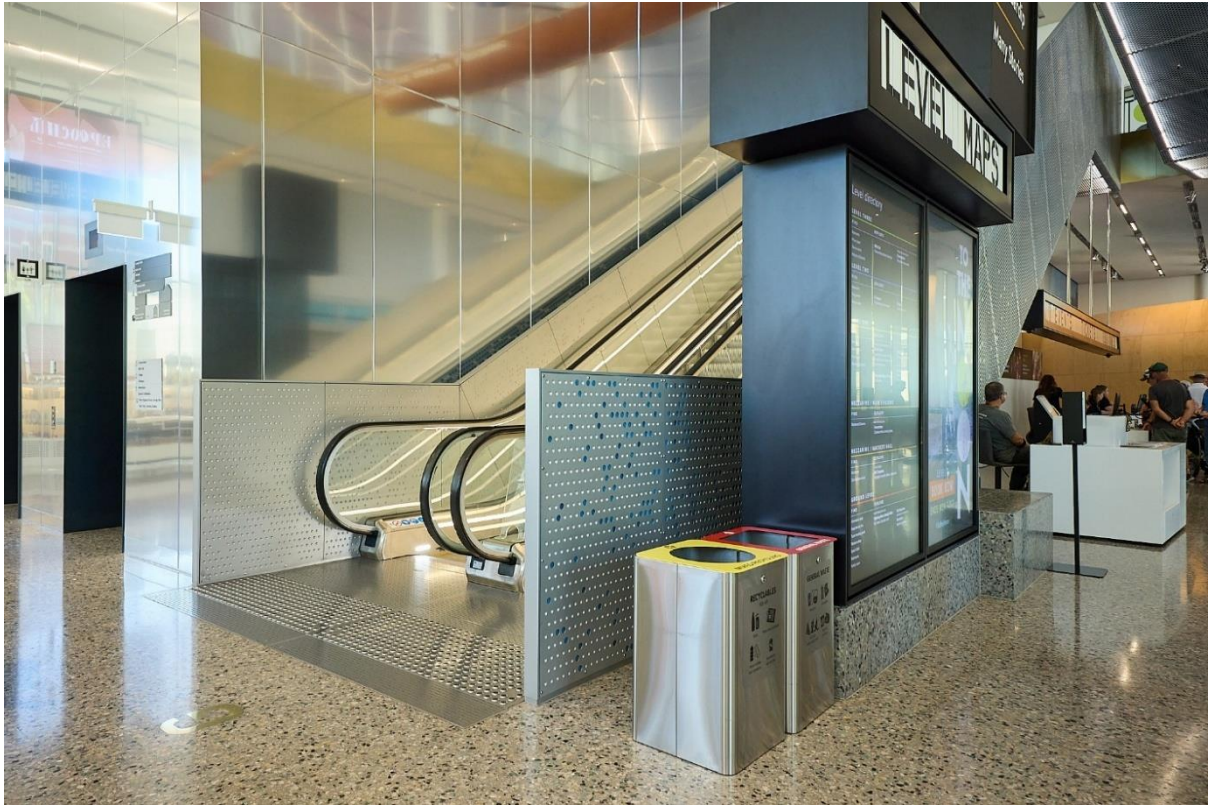

Once you have purchased your tickets, if you turn left, you will see an escalator that will take you up to the exhibit. Elevators are also available beside.

You will want to go to Level 1 for the 'OceanXperience' exhibit.



When you arrive at the exhibit, a museum volunteer will help you register.

You may need to wait for a short time.

While you wait, you can look at the marine specimens on display.



Here you will register for the exhibit.

A museum volunteer will help you.

You will type your name and choose which mission you would like to do first.

There is a choice of three.



You will be given a wristband to wear during the exhibit. You can tap your wristband at different checkpoints throughout the exhibit.

The wristband helps the exhibit recognise you at each checkpoint. It can provide instructions and information as you move through the exhibit.

Now you are ready to enter the exhibit.

Enjoy your visit!



When you enter the exhibit, you will see a map. The map shows the layout of the exhibit and the order of the missions.

The available missions are Humpback Whales, Great Hammerhead Sharks, and Orcas.

The exhibit has different mission areas to explore. Some areas include screens, sounds, lighting effects, and interactive activities.

You may visit areas such as Mission Control, the Bridge, the Wet Lab, and the Dry Lab during your journey.



In this area, you can colour in a sea creature on a monitor and see it appear on the large screen. You can also control a submarine to search for your sea creature underwater.

You can choose to watch, play, or sit on the seats.

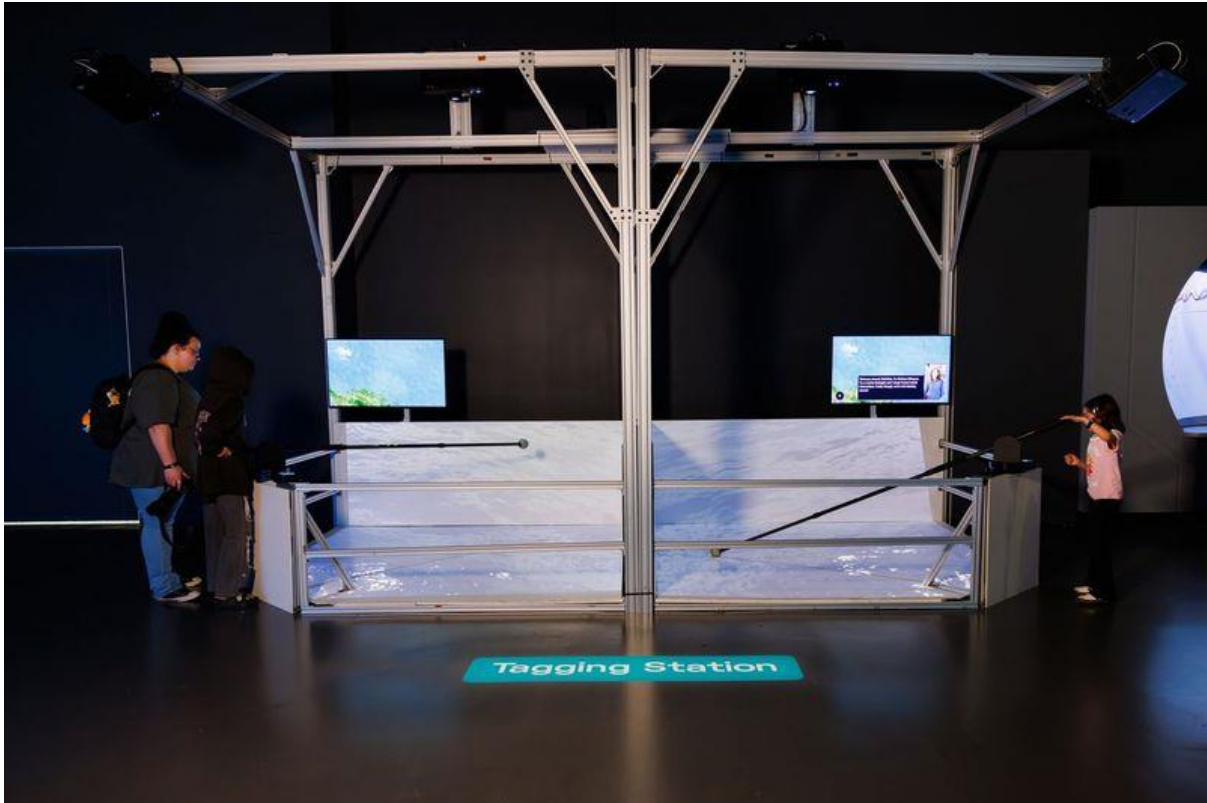

At this station, you can take part in a whale research activity. You can try tagging a whale to help scientists track and study whales in the ocean.

This activity includes screens, movement, and interactive controls.



This area includes a variety of interactive activities and displays. Visitors can explore different stations, watch videos and animations, and take part in hands-on experiences throughout the exhibit.

Some areas may include sounds, lighting effects, and moving images.



There is a LEGO station where visitors can sit and build. This area may have background noise and other people nearby.



Throughout the exhibit, there are information displays about marine animals such as humpback whales and orcas. Visitors can stop to read information and look at pictures and videos.



This area is called the Sub Hangar. Here, visitors can learn about underwater vehicles used to explore the deep ocean.

There are displays, equipment, and interactive activities about submarines, robots, and ocean research.



There are places in the exhibit where you can sit and relax. Some areas have chairs and bean bags where visitors can take a break, watch videos, or rest during their visit.



The Wet Lab is an area where scientists study sea animals and ocean samples. Visitors can learn how scientists research marine life from the deep ocean.

This area may include screens, lighting effects, and interactive displays



In the Dry Lab, visitors can learn how scientists study samples and information from the ocean. You can also listen to the sound of a whale in this area.



After you have visited all three missions, you will finish the exhibit. Before leaving, please place your wristband in the collection bins.



At the end of the exhibit, visitors can choose to try the HoloLab experience.

Visitors wear a special headset to see holograms and learn about ocean science and marine animals. A staff member will help guide the activity.

Participation is optional. Visitors can still enjoy the exhibit without taking part in HoloLab.

There may be a short wait, as places are limited.



Before leaving the exhibit, visitors can explore the displayed marine specimens and learn more about ocean life.

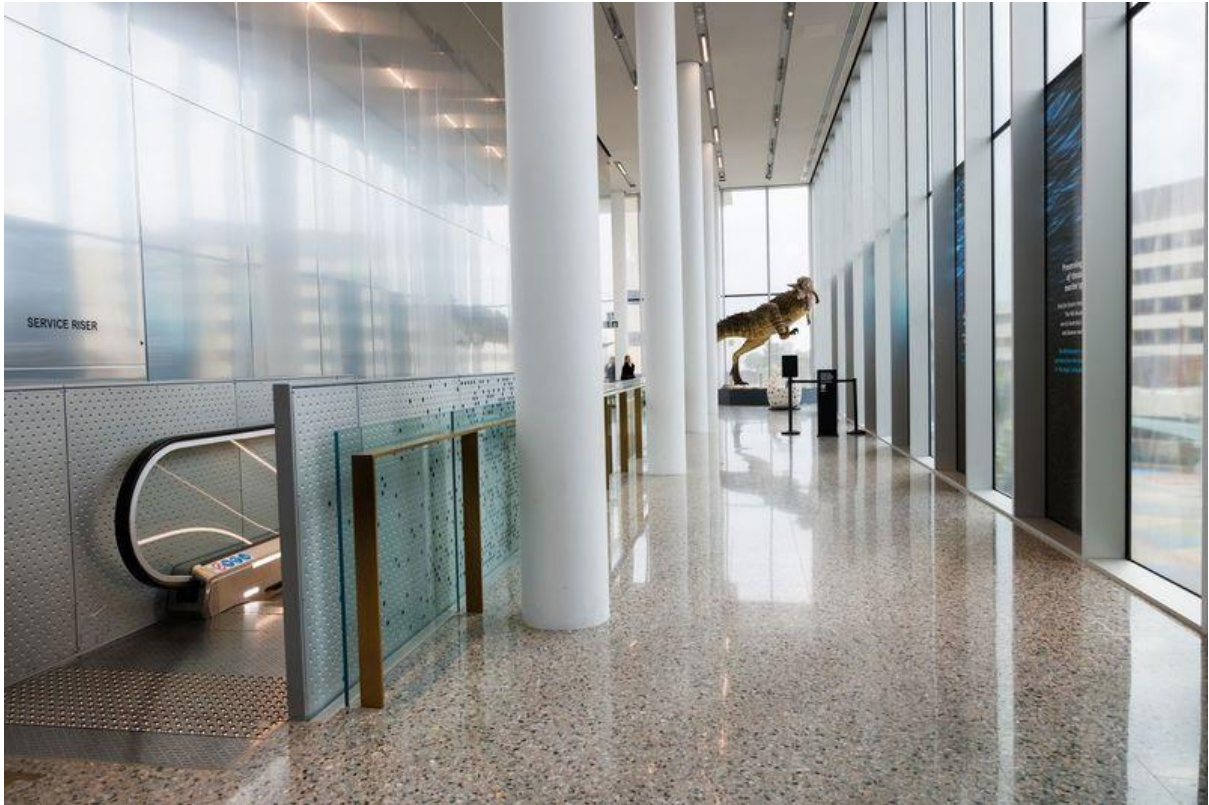

Thank you for visiting OceanXperience!

When you are ready, you can leave and explore the rest of the Museum at your own pace.